

Wkręt dociskowy (ustalający)
z gniazdem sześciokątnym, z czopem

DIN 915
PN/M-82316
ISO 4028

Materiał: stal, A2

Powłoka ochronna: ocynk

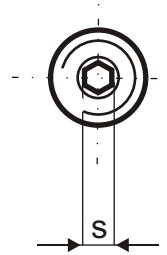
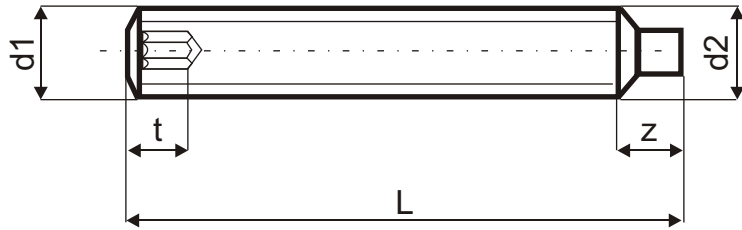

| d1 | M 3 | M 4 | M 5 | M 6 | M 8 | M 10 | M 12 | M 16 | M 20 | M 24 |
|---------|--------|--------|----------|----------|--------|----------|--------|-------|-------|----------|
| d2 max. | 2 | 2,5 | 3,5 | 4 | 5,5 | 7 | 8,5 | 12 | 15 | 18 |
| s | 1,5 | 2 | 2,5 | 3 | 4 | 5 | 6 | 8 | 10 | 12 |
| z min. | 0,75-1 | 1-1,25 | 1,25-1,5 | 1,5-1,75 | 2-2,25 | 2,5-2,75 | 3-3,25 | 4-4,3 | 5-5,5 | 12-12,43 |
| t min. | 1,2 | 1,5 | 2 | 2 | 3 | 4 | 4,8 | 6,4 | 8 | 10 |

| d1 mm | L mm | stal surowa | A2 |
|----------|---------|-------------|---------|
| | | 091550 | 091520 |
| M 3 | 4,0 | 030-004 | 030-004 |
| | 5,0 | 030-005 | 030-005 |
| | 6,0 | 030-006 | 030-006 |
| | 8,0 | 030-008 | 030-008 |
| | 10,0 | 030-100 | 030-100 |
| | 12,0 | 030-120 | 030-120 |
| | 14,0 | 030-140 | |
| | 16,0 | 030-160 | 030-160 |
| M 4 | 5,0 | 040-005 | 040-005 |
| | 6,0 | 040-006 | 040-006 |
| | 8,0 | 040-008 | 040-008 |
| | 10,0 | 040-010 | 040-010 |
| | 12,0 | 040-012 | 040-012 |
| | 14,0 | 040-014 | |
| | 16,0 | 040-016 | 040-016 |
| | 20,0 | 040-020 | 040-020 |
| | 25,0 | 040-025 | 040-025 |
| | 30,0 | 040-030 | 040-030 |
| M 5 | 6,0 | 050-006 | 050-006 |
| | 8,0 | 050-008 | 050-008 |
| | 10,0 | 050-010 | 050-010 |
| | 12,0 | 050-012 | 050-012 |
| | 14,0 | 050-014 | |
| | 16,0 | 050-016 | 050-016 |
| | 20,0 | 050-020 | 050-020 |
| | 25,0 | 050-025 | 050-025 |
| | 30,0 | 050-030 | 050-030 |
| | 40,0 | 050-040 | 050-040 |

| d1 mm | L mm | stal surowa | A2 |
|----------|---------|-------------|---------|
| | | 091550 | 091520 |
| M 6 | 6,0 | 060-006 | 060-006 |
| | 8,0 | 060-008 | 060-008 |
| | 10,0 | 060-010 | 060-010 |
| | 12,0 | 060-012 | 060-012 |
| | 14,0 | 060-014 | |
| | 16,0 | 060-016 | 060-016 |
| | 18,0 | 060-018 | |
| | 20,0 | 060-020 | 060-020 |
| | 25,0 | 060-025 | 060-025 |
| | 30,0 | 060-030 | 060-030 |
| | 35,0 | 060-035 | 060-035 |
| | 40,0 | 060-040 | 060-040 |
| M 8 | 45,0 | 060-045 | 060-045 |
| | 50,0 | 060-050 | 060-050 |
| | 60,0 | | 060-060 |
| | 10,0 | 080-010 | 080-010 |
| | 12,0 | 080-012 | 080-012 |
| | 14,0 | 080-014 | |
| | 16,0 | 080-016 | 080-016 |
| | 18,0 | 080-018 | |
| | 20,0 | 080-020 | 080-020 |
| | 22,0 | 080-022 | |
| | 25,0 | 080-025 | 080-025 |
| | 30,0 | 080-030 | 080-030 |
| | 35,0 | 080-035 | 080-035 |
| | 40,0 | 080-040 | 080-040 |
| | 45,0 | 080-045 | 080-045 |
| | 50,0 | 080-050 | 080-050 |
| | 60,0 | 080-060 | 080-060 |

| d1 mm | L mm | stal surowa 091550 | A2 091520 |
|-----------------|----------------|------------------------------|---------------------|
| M 10 | 12,0 | 100-012 | 100-012 |
| | 14,0 | 100-014 | |
| | 16,0 | 100-016 | 100-016 |
| | 18,0 | 100-018 | |
| | 20,0 | 100-020 | 100-020 |
| | 22,0 | 100-022 | |
| | 25,0 | 100-025 | 100-025 |
| | 30,0 | 100-030 | 100-030 |
| | 35,0 | 100-035 | 100-035 |
| | 40,0 | 100-040 | 100-040 |
| | 45,0 | 100-045 | 100-045 |
| | 50,0 | 100-050 | 100-050 |
| | 60,0 | 100-060 | 100-060 |
| | 70,0 | 100-070 | |
| 80,0 | 100-080 | | |
| M 12 | 16,0 | 120-016 | 120-016 |
| | 18,0 | 120-018 | |
| | 20,0 | 120-020 | 120-020 |
| | 25,0 | 120-025 | 120-025 |
| | 30,0 | 120-030 | 120-030 |
| | 35,0 | 120-035 | 120-035 |
| | 40,0 | 120-040 | 120-040 |
| | 45,0 | 120-045 | 120-045 |
| | 50,0 | 120-050 | 120-050 |
| | 60,0 | 120-060 | 120-060 |
| | 70,0 | 120-070 | 120-070 |
| 80,0 | 120-080 | 120-080 | |

| d1 mm | L mm | stal surowa 091550 | A2 091520 |
|-----------------|----------------|------------------------------|---------------------|
| M 16 | 20,0 | 160-020 | 160-020 |
| | 25,0 | 160-025 | 160-025 |
| | 30,0 | 160-030 | 160-030 |
| | 35,0 | 160-035 | 160-035 |
| | 40,0 | 160-040 | 160-040 |
| | 45,0 | 160-045 | 160-045 |
| | 50,0 | 160-050 | 160-050 |
| | 60,0 | 160-060 | 160-060 |
| | 70,0 | 160-070 | 160-070 |
| | 80,0 | 160-080 | 160-080 |
| | M 20 | 20,0 | 200-020 |
| 25,0 | | 200-025 | 200-025 |
| 30,0 | | 200-030 | 200-030 |
| 35,0 | | 200-035 | 200-035 |
| 40,0 | | 200-040 | 200-040 |
| 45,0 | | 200-045 | 200-045 |
| 50,0 | | 200-050 | 200-050 |
| 60,0 | | 200-060 | 200-060 |
| M 24 | 70,0 | 200-070 | 200-070 |
| | 80,0 | 200-080 | 200-080 |
| | 30,0 | 240-030 | |
| | 35,0 | 240-035 | |
| | 40,0 | 240-040 | |
| | 50,0 | 240-050 | |
| | 60,0 | 240-060 | |
| | 70,0 | 240-070 | |
| 80,0 | 240-080 | | |