

Śruba z łbem walcowym z gniazdem sześciokątnym

DIN 912
PN/M-82302
ISO 4762

Materiał: stal, A2

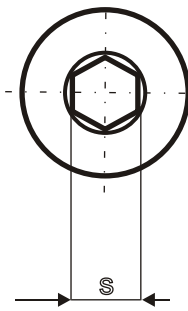
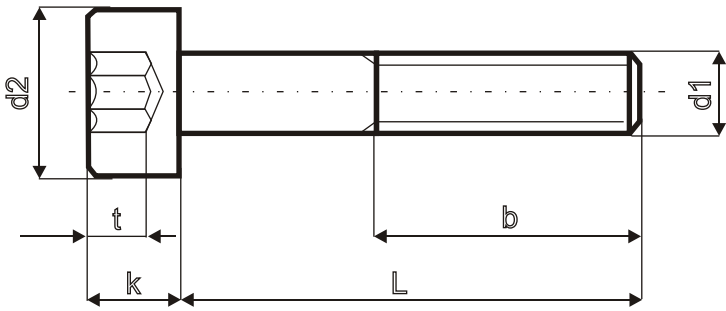

| d1 | M 3 | M 4 | M 5 | M 6 | M 8 | M 10 | M 12 | M 14 | M 16 | M 18 | M 20 | M 22 | M 24 | M 27 |
|--------|-----|-----|-----|-----|-----|------|------|------|------|------|------|------|------|------|
| d2 | 5,5 | 7 | 8,5 | 10 | 13 | 16 | 18 | 21 | 24 | 27 | 30 | 33 | 36 | 40 |
| b | 18 | 20 | 22 | 24 | 28 | 32 | 36 | 40 | 44 | 48 | 52 | 56 | 60 | 66 |
| k | 3 | 4 | 5 | 6 | 8 | 10 | 12 | 14 | 16 | 18 | 20 | 22 | 24 | 27 |
| s | 2,5 | 3 | 4 | 5 | 6 | 8 | 10 | 12 | 14 | 14 | 17 | 17 | 19 | 19 |
| t min. | 1,3 | 2 | 2,5 | 3 | 4 | 5 | 6 | 7 | 8 | 9 | 10 | 11 | 12 | 13,5 |

| d1 mm | L mm | stal 8.8 091280 | stal 12.9 091290 | A2 091220 |
|----------|---------|--------------------|---------------------|--------------|
| M 3 | 4,0 | 030-004 | 030-004 | 030-004 |
| | 5,0 | 030-005 | 030-005 | 030-005 |
| | 6,0 | 030-006 | 030-006 | 030-006 |
| | 8,0 | 030-008 | 030-008 | 030-008 |
| | 10,0 | 030-010 | 030-010 | 030-010 |
| | 12,0 | 030-012 | 030-012 | 030-012 |
| | 14,0 | 030-014 | 030-014 | 030-014 |
| | 16,0 | 030-016 | 030-016 | 030-016 |
| | 18,0 | 030-018 | 030-018 | 030-018 |
| | 20,0 | 030-020 | 030-020 | 030-020 |
| | 22,0 | 030-022 | 030-022 | 030-022 |
| | 25,0 | 030-025 | 030-025 | 030-025 |
| | 30,0 | 030-030 | 030-030 | 030-030 |
| | 35,0 | 030-035 | 030-035 | 030-035 |
| 40,0 | 030-040 | 030-040 | 030-040 | |
| M 4 | 5,0 | 040-005 | 040-005 | 040-005 |
| | 6,0 | 040-006 | 040-006 | 040-006 |
| | 8,0 | 040-008 | 040-008 | 040-008 |
| | 10,0 | 040-010 | 040-010 | 040-010 |
| | 12,0 | 040-012 | 040-012 | 040-012 |
| | 14,0 | 040-014 | 040-014 | 040-014 |
| | 16,0 | 040-016 | 040-016 | 040-016 |
| | 18,0 | 040-018 | 040-018 | 040-018 |
| | 20,0 | 040-020 | 040-020 | 040-020 |
| | 22,0 | 040-022 | 040-022 | 040-022 |
| | 25,0 | 040-025 | 040-025 | 040-025 |
| | 30,0 | 040-030 | 040-030 | 040-030 |

| d1 mm | L mm | stal 8.8 091280 | stal 12.9 091290 | A2 091220 |
|----------|---------|--------------------|---------------------|--------------|
| M 4 | 35,0 | 040-035 | 040-035 | 040-035 |
| | 40,0 | 040-040 | 040-040 | 040-040 |
| | 45,0 | 040-045 | 040-045 | 040-045 |
| | 50,0 | 040-050 | 040-050 | 040-050 |
| | 60,0 | 040-060 | 040-060 | 040-060 |
| | 70,0 | 040-070 | 040-070 | 040-070 |
| | 80,0 | 040-080 | 040-080 | 040-080 |
| | M 5 | 6,0 | 050-006 | 050-006 |
| 8,0 | | 050-008 | 050-008 | 050-008 |
| 10,0 | | 050-010 | 050-010 | 050-010 |
| 12,0 | | 050-012 | 050-012 | 050-012 |
| 14,0 | | 050-014 | 050-014 | 050-014 |
| 16,0 | | 050-016 | 050-016 | 050-016 |
| 18,0 | | 050-018 | 050-018 | 050-018 |
| 20,0 | | 050-020 | 050-020 | 050-020 |
| 22,0 | | 050-022 | 050-022 | 050-022 |
| 25,0 | | 050-025 | 050-025 | 050-025 |
| 30,0 | | 050-030 | 050-030 | 050-030 |
| 35,0 | | 050-035 | 050-035 | 050-035 |
| 40,0 | | 050-040 | 050-040 | 050-040 |
| 45,0 | | 050-045 | 050-045 | 050-045 |
| 50,0 | | 050-050 | 050-050 | 050-050 |
| 55,0 | | 050-055 | 050-055 | 050-055 |
| 60,0 | | 050-060 | 050-060 | 050-060 |
| 65,0 | | | 050-065 | 050-065 |
| 70,0 | | 050-070 | 050-070 | 050-070 |
| 80,0 | | 050-080 | 050-080 | 050-080 |
| 90,0 | | 050-090 | 050-090 | 050-090 |
| 100,0 | | 050-100 | 050-100 | 050-100 |

| d1 mm | L mm | stal 8.8 091280 | stal 12.9 091290 | A2 091220 |
|-----------------|----------------|---------------------------|----------------------------|---------------------|
| M 6 | 6,0 | 060-006 | 060-006 | |
| | 8,0 | 060-008 | 060-008 | 060-008 |
| | 10,0 | 060-010 | 060-010 | 060-010 |
| | 12,0 | 060-012 | 060-012 | 060-012 |
| | 14,0 | 060-014 | 060-014 | 060-014 |
| | 16,0 | 060-016 | 060-016 | 060-016 |
| | 18,0 | 060-018 | 060-018 | 060-018 |
| | 20,0 | 060-020 | 060-020 | 060-020 |
| | 22,0 | 060-022 | 060-022 | 060-022 |
| | 25,0 | 060-025 | 060-025 | 060-025 |
| | 30,0 | 060-030 | 060-030 | 060-030 |
| | 35,0 | 060-035 | 060-035 | 060-035 |
| | 40,0 | 060-040 | 060-040 | 060-040 |
| | 45,0 | 060-045 | 060-045 | 060-045 |
| | 50,0 | 060-050 | 060-050 | 060-050 |
| | 55,0 | 060-055 | 060-055 | 060-055 |
| | 60,0 | 060-060 | 060-060 | 060-060 |
| | 65,0 | 060-065 | 060-065 | 060-065 |
| 70,0 | 060-070 | 060-070 | 060-070 | |
| 75,0 | 060-075 | 060-075 | 060-075 | |
| 80,0 | 060-080 | 060-080 | 060-080 | |
| 90,0 | 060-090 | 060-090 | 060-090 | |
| 100,0 | 060-100 | 060-100 | 060-100 | |
| 120,0 | 060-120 | 060-120 | 060-120 | |
| M 8 | 10,0 | 080-010 | 080-010 | 080-010 |
| | 12,0 | 080-012 | 080-012 | 080-012 |
| | 14,0 | 080-014 | 080-014 | 080-014 |
| | 16,0 | 080-016 | 080-016 | 080-016 |
| | 18,0 | 080-018 | 080-018 | 080-018 |
| | 20,0 | 080-020 | 080-020 | 080-020 |
| | 22,0 | 080-022 | 080-022 | 080-022 |
| | 25,0 | 080-025 | 080-025 | 080-025 |
| | 30,0 | 080-030 | 080-030 | 080-030 |
| | 35,0 | 080-035 | 080-035 | 080-035 |
| | 40,0 | 080-040 | 080-040 | 080-040 |
| | 45,0 | 080-045 | 080-045 | 080-045 |
| | 50,0 | 080-050 | 080-050 | 080-050 |
| | 55,0 | 080-055 | 080-055 | 080-055 |
| | 60,0 | 080-060 | 080-060 | 080-060 |
| | 65,0 | 080-065 | 080-065 | 080-065 |
| | 70,0 | 080-070 | 080-070 | 080-070 |
| | 75,0 | 080-075 | 080-075 | 080-075 |
| | 80,0 | 080-080 | 080-080 | 080-080 |
| | 85,0 | 080-085 | | |
| 90,0 | 080-090 | 080-090 | 080-090 | |
| 100,0 | 080-100 | 080-100 | 080-100 | |

| d1 mm | L mm | stal 8.8 091280 | stal 12.9 091290 | A2 091220 | |
|-----------------|----------------|---------------------------|----------------------------|---------------------|--|
| M 8 | 110,0 | 080-110 | 080-110 | 080-110 | |
| | 120,0 | 080-120 | 080-120 | 080-120 | |
| | 130,0 | 080-130 | 080-130 | 080-130 | |
| | 140,0 | 080-140 | 080-140 | 080-140 | |
| | 150,0 | 080-150 | 080-150 | 080-150 | |
| | 160,0 | 080-160 | 080-160 | 080-160 | |
| | 180,0 | 080-180 | 080-180 | 080-180 | |
| | 200,0 | 080-200 | 080-200 | | |
| | 220,0 | 080-220 | 080-220 | | |
| | 240,0 | 080-240 | 080-240 | | |
| | 260,0 | 080-260 | 080-260 | | |
| | 280,0 | 080-280 | 080-280 | | |
| | 300,0 | 080-300 | 080-300 | | |
| | M 10 | 12,0 | 100-012 | 100-012 | |
| | | 14,0 | 100-014 | 100-014 | |
| 16,0 | | 100-016 | 100-016 | 100-016 | |
| 18,0 | | 100-018 | 100-018 | 100-018 | |
| 20,0 | | 100-020 | 100-020 | 100-020 | |
| 22,0 | | 100-022 | 100-022 | | |
| 25,0 | | 100-025 | 100-025 | 100-025 | |
| 30,0 | | 100-030 | 100-030 | 100-030 | |
| 35,0 | | 100-035 | 100-035 | 100-035 | |
| 40,0 | | 100-040 | 100-040 | 100-040 | |
| 45,0 | | 100-045 | 100-045 | 100-045 | |
| 50,0 | | 100-050 | 100-050 | 100-050 | |
| 55,0 | | 100-055 | 100-055 | 100-055 | |
| 60,0 | | 100-060 | 100-060 | 100-060 | |
| 65,0 | | 100-065 | 100-065 | 100-065 | |
| 70,0 | | 100-070 | 100-070 | 100-070 | |
| 75,0 | | 100-075 | 100-075 | 100-075 | |
| 80,0 | | 100-080 | 100-080 | 100-080 | |
| 85,0 | | 100-085 | 100-085 | | |
| 90,0 | | 100-090 | 100-090 | 100-090 | |
| 100,0 | | 100-100 | 100-100 | 100-100 | |
| 110,0 | | 100-110 | 100-110 | 100-110 | |
| 120,0 | | 100-120 | 100-120 | 100-120 | |
| 130,0 | | 100-130 | 100-130 | 100-130 | |
| 140,0 | | 100-140 | 100-140 | 100-140 | |
| 150,0 | 100-150 | 100-150 | 100-150 | | |
| 160,0 | 100-160 | 100-160 | 100-160 | | |
| 180,0 | 100-180 | 100-180 | 100-180 | | |
| 200,0 | 100-200 | 100-200 | | | |
| 220,0 | 100-220 | 100-220 | | | |
| 240,0 | 100-240 | 100-240 | | | |
| 260,0 | 100-260 | 100-260 | | | |
| 300,0 | 100-300 | 100-300 | | | |

| d1 mm | L mm | stal 8.8 091280 | stal 12.9 091290 | A2 091220 |
|-----------------|----------------|---------------------------|----------------------------|---------------------|
| M 12 | 16,0 | 120-016 | 120-016 | 120-016 |
| | 18,0 | 120-018 | 120-018 | |
| | 20,0 | 120-020 | 120-020 | 120-020 |
| | 22,0 | 120-022 | 120-022 | |
| | 25,0 | 120-025 | 120-025 | 120-025 |
| | 30,0 | 120-030 | 120-030 | 120-030 |
| | 35,0 | 120-035 | 120-035 | 120-035 |
| | 40,0 | 120-040 | 120-040 | 120-040 |
| | 45,0 | 120-045 | 120-045 | 120-045 |
| | 50,0 | 120-050 | 120-050 | 120-050 |
| | 55,0 | 120-055 | 120-055 | 120-055 |
| | 60,0 | 120-060 | 120-060 | 120-060 |
| | 65,0 | 120-065 | 120-065 | 120-065 |
| | 70,0 | 120-070 | 120-070 | 120-070 |
| | 75,0 | 120-075 | 120-075 | 120-075 |
| | 80,0 | 120-080 | 120-080 | 120-080 |
| | 85,0 | 120-085 | | |
| | 90,0 | 120-090 | 120-090 | 120-090 |
| | 100,0 | 120-100 | 120-100 | 120-100 |
| | 110,0 | 120-110 | 120-110 | 120-110 |
| | 120,0 | 120-120 | 120-120 | 120-120 |
| | 130,0 | 120-130 | 120-130 | 120-130 |
| | 140,0 | 120-140 | 120-140 | 120-140 |
| | 150,0 | 120-150 | 120-150 | 120-150 |
| | 160,0 | 120-160 | 120-160 | 120-160 |
| | 180,0 | 120-180 | 120-180 | 120-180 |
| | 200,0 | 120-200 | 120-200 | |
| | 220,0 | 120-220 | 120-220 | |
| 240,0 | 120-240 | 120-240 | | |
| 260,0 | 120-260 | 120-260 | | |
| 280,0 | 120-280 | 120-280 | | |
| 300,0 | 120-300 | 120-300 | | |
| M 14 | 25,0 | 140-025 | 140-025 | 140-025 |
| | 30,0 | 140-030 | 140-030 | 140-030 |
| | 35,0 | 140-035 | 140-035 | 140-035 |
| | 40,0 | 140-040 | 140-040 | 140-040 |
| | 45,0 | 140-045 | 140-045 | 140-045 |
| | 50,0 | 140-050 | 140-050 | 140-050 |
| | 55,0 | 140-055 | 140-055 | 140-055 |
| | 60,0 | 140-060 | 140-060 | 140-060 |
| | 65,0 | 140-065 | 140-065 | 140-065 |
| | 70,0 | 140-070 | 140-070 | 140-070 |
| | 75,0 | 140-075 | 140-075 | 140-075 |
| | 80,0 | 140-080 | 140-080 | 140-080 |
| | 85,0 | 140-085 | | |
| | 90,0 | 140-090 | 140-090 | 140-090 |
| 100,0 | 140-100 | 140-100 | 140-100 | |
| 110,0 | 140-110 | 140-110 | 140-110 | |

| d1 mm | L mm | stal 8.8 091280 | stal 12.9 091290 | A2 091220 |
|-----------------|----------------|---------------------------|----------------------------|---------------------|
| M 14 | 120,0 | 140-120 | 140-120 | 140-120 |
| | 130,0 | 140-130 | 140-130 | 140-130 |
| | 140,0 | 140-140 | 140-140 | 140-140 |
| | 150,0 | 140-150 | 140-150 | 140-150 |
| | 160,0 | 140-160 | 140-160 | |
| | 180,0 | 140-180 | 140-180 | |
| | 200,0 | 140-200 | 140-200 | |
| | M 16 | 25,0 | 160-025 | 160-025 |
| 30,0 | | 160-030 | 160-030 | 160-030 |
| 35,0 | | 160-035 | 160-035 | 160-035 |
| 40,0 | | 160-040 | 160-040 | 160-040 |
| 45,0 | | 160-045 | 160-045 | 160-045 |
| 50,0 | | 160-050 | 160-050 | 160-050 |
| 55,0 | | 160-055 | 160-055 | 160-055 |
| 60,0 | | 160-060 | 160-060 | 160-060 |
| 65,0 | | 160-065 | 160-065 | 160-065 |
| 70,0 | | 160-070 | 160-070 | 160-070 |
| 75,0 | | 160-075 | 160-075 | 160-075 |
| 80,0 | | 160-080 | 160-080 | 160-080 |
| 85,0 | | 160-085 | | |
| 90,0 | | 160-090 | 160-090 | 160-090 |
| 100,0 | | 160-100 | 160-100 | 160-100 |
| 110,0 | | 160-110 | 160-110 | 160-110 |
| 120,0 | | 160-120 | 160-120 | 160-120 |
| 130,0 | | 160-130 | 160-130 | 160-130 |
| 140,0 | | 160-140 | 160-140 | 160-140 |
| 150,0 | | 160-150 | 160-150 | 160-150 |
| 160,0 | | 160-160 | 160-160 | 160-160 |
| 180,0 | | 160-180 | 160-180 | 160-180 |
| 200,0 | | 160-200 | 160-200 | 160-200 |
| 220,0 | | 160-220 | 160-220 | |
| 240,0 | 160-240 | 160-240 | | |
| 260,0 | 160-260 | 160-260 | | |
| 300,0 | 160-300 | 160-300 | | |
| M 18 | 35,0 | 180-035 | 180-035 | |
| | 40,0 | 180-040 | 180-040 | 180-040 |
| | 45,0 | 180-045 | 180-045 | 180-045 |
| | 50,0 | 180-050 | 180-050 | 180-050 |
| | 55,0 | 180-055 | 180-055 | 180-055 |
| | 60,0 | 180-060 | 180-060 | 180-060 |
| | 70,0 | 180-070 | 180-070 | 180-070 |
| | 80,0 | 180-080 | 180-080 | 180-080 |
| | 90,0 | 180-090 | 180-090 | 180-090 |
| | 100,0 | 180-100 | 180-100 | 180-100 |
| | 110,0 | 180-110 | 180-110 | 180-110 |
| | 120,0 | 180-120 | 180-120 | 180-120 |
| | 130,0 | 180-130 | 180-130 | 180-130 |
| | 140,0 | 180-140 | 180-140 | 180-140 |

| d1 mm | L mm | stal 8.8 091280 | stal 12.9 091290 | A2 091220 |
|-----------------|----------------|---------------------------|----------------------------|---------------------|
| M 20 | 35,0 | 200-035 | 200-035 | 200-035 |
| | 40,0 | 200-040 | 200-040 | 200-040 |
| | 45,0 | 200-045 | 200-045 | 200-045 |
| | 50,0 | 200-050 | 200-050 | 200-050 |
| | 55,0 | 200-055 | 200-055 | 200-055 |
| | 60,0 | 200-060 | 200-060 | 200-060 |
| | 65,0 | 200-065 | 200-065 | 200-065 |
| | 70,0 | 200-070 | 200-070 | 200-070 |
| | 80,0 | 200-080 | 200-080 | 200-080 |
| | 90,0 | 200-090 | 200-090 | 200-090 |
| | 100,0 | 200-100 | 200-100 | 200-100 |
| | 110,0 | 200-110 | 200-110 | 200-110 |
| | 120,0 | 200-120 | 200-120 | 200-120 |
| | 130,0 | 200-130 | 200-130 | 200-130 |
| | 140,0 | 200-140 | 200-140 | 200-140 |
| | 150,0 | 200-150 | 200-150 | 200-150 |
| | 160,0 | 200-160 | 200-160 | 200-160 |
| | 180,0 | 200-180 | 200-180 | 200-180 |
| | 200,0 | 200-200 | 200-200 | 200-200 |
| | 220,0 | 200-220 | 200-220 | |
| 240,0 | 200-240 | 200-240 | | |
| 260,0 | 200-260 | 200-260 | | |
| 300,0 | 200-300 | 200-300 | | |
| M 22 | 40,0 | 220-040 | 220-040 | |
| | 45,0 | 220-045 | 220-045 | |
| | 50,0 | 220-050 | 220-050 | |
| | 55,0 | 220-055 | | |
| | 60,0 | 220-060 | 220-060 | |
| | 70,0 | 220-070 | 220-070 | |
| | 80,0 | 220-080 | 220-080 | |
| | 90,0 | 220-090 | 220-090 | |
| | 100,0 | 220-100 | 220-100 | |
| | 110,0 | 220-110 | 220-110 | |
| | 120,0 | 220-120 | 220-120 | |
| | 140,0 | 220-140 | | |
| | 150,0 | 220-150 | | |

| d1 mm | L mm | stal 8.8 091280 | stal 12.9 091290 | A2 091220 |
|-----------------|----------------|---------------------------|----------------------------|---------------------|
| M 24 | 40,0 | 240-040 | 240-040 | 240-040 |
| | 45,0 | | 240-045 | 240-045 |
| | 50,0 | 240-050 | 240-050 | 240-050 |
| | 55,0 | 240-055 | 240-055 | 240-055 |
| | 60,0 | 240-060 | 240-060 | 240-060 |
| | 70,0 | 240-070 | 240-070 | 240-070 |
| | 75,0 | 240-075 | | 240-075 |
| | 80,0 | 240-080 | 240-080 | 240-080 |
| | 90,0 | 240-090 | 240-090 | 240-090 |
| | 100,0 | 240-100 | 240-100 | 240-100 |
| | 110,0 | 240-110 | 240-110 | 240-110 |
| | 120,0 | 240-120 | 240-120 | 240-120 |
| | 130,0 | 240-130 | 240-130 | 240-130 |
| | 140,0 | 240-140 | 240-140 | 240-140 |
| | 150,0 | 240-150 | 240-150 | 240-150 |
| | 160,0 | 240-160 | 240-160 | 240-160 |
| | 180,0 | 240-180 | 240-180 | 240-180 |
| | 200,0 | 240-200 | 240-200 | 240-200 |
| | 220,0 | 240-220 | 240-220 | |
| | 240,0 | 240-240 | 240-240 | |
| 260,0 | 240-260 | 240-260 | | |
| 300,0 | 240-300 | 240-300 | | |
| M 27 | 70,0 | 270-070 | 270-070 | 270-070 |
| | 80,0 | 270-080 | 270-080 | 270-080 |
| | 90,0 | 270-090 | 270-090 | 270-090 |
| | 100,0 | 270-100 | 270-100 | 270-100 |
| | 120,0 | 270-120 | 270-120 | 270-120 |
| | 140,0 | 270-140 | 270-140 | 270-140 |
| | 160,0 | 270-160 | 270-160 | |
| | 180,0 | 270-180 | 270-180 | |
| | 200,0 | 270-200 | 270-200 | |
| | 220,0 | 270-220 | | |
| | 240,0 | 270-240 | 270-240 | |
| | 260,0 | 270-260 | 270-260 | |
| | 280,0 | 270-280 | | |
| 300,0 | 270-300 | 270-300 | | |